







CLIENT / OWNER

---

**HARRIS AND ROCKY, LLC**  
AGENT: HANUMANTHA CHEKURI  
11617 ELIZABETH MADISON COURT  
CHARLOTTE, NC 28277

KEY MAP

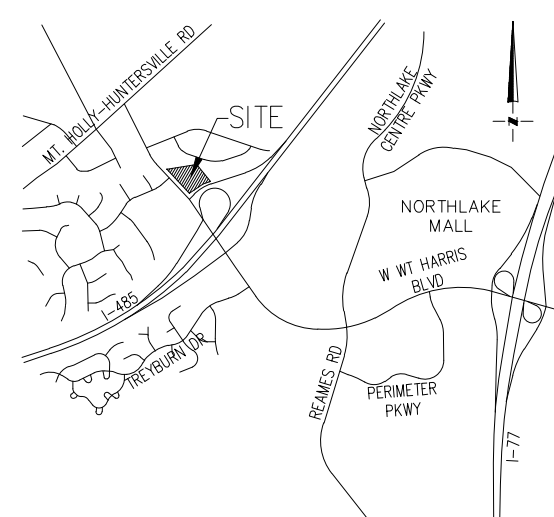

PROJECT

# CROSSWINDS TRACE APARTMENTS

PROJECT NUMBER  
22019

DATE  
01/17/23

ISSUED FOR

## REZONING PETITION 2022-090

[illegible]

PROJ. MANAGER: BS  
DRAWN BY: KO  
CHECKED BY: BS

SEAL

SCALE \_\_\_\_\_  
AS INDICATED

DRAWING

## SCHEMATIC ILLUSTRATIVE PLAN

**RZ2.00**

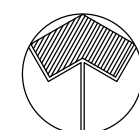

SCALE: 1" = 40'

The profile view shows a cross-section of the roadbed. The horizontal axis represents stationing from 0 to 80 feet. The vertical axis represents elevation. The roadbed is shown as a series of rectangular blocks. The first block is from station 0 to 20 feet, with a height of 10 feet. The second block is from station 20 to 40 feet, with a height of 10 feet. The third block is from station 40 to 80 feet, with a height of 10 feet. The ground surface is shown as a dashed line below the roadbed. The elevation of the ground surface is 0 feet at station 0, rises to 10 feet at station 20, and remains at 10 feet until station 80.

COPYRIGHT © 2022 DPR ASSOCIATES, INC. THE PLAN OR DRAWING AND ANY ACCOMPANYING DOCUMENTS OR CALCULATIONS ARE THE PROPERTY OF DPR ASSOCIATES, INC. AND ARE INTENDED SOLELY FOR THE USE OF THE RECIPIENT NOTED. NO THIRD PARTY USE OR MODIFICATION IS PERMITTED WITHOUT WRITTEN AUTHORIZATION.

ORIGINAL SHEET SIZE: 24" X 36"

Plotted: 22019-PLAN-REZN.dwg / 1/17/2023 10:14 AM