

# Rezoning Transportation Analysis

Petition Number: 2022-146

General Location Identifier: 10910206

**From:** Jake Carpenter, PE

Jacob.carpenter@charlottenc.gov

980-221-5675

**Reviewer:**

Isaiah Washington

Isaiah.Washington@charlottenc.gov

980-275-2494

## Revision Log:

Date	Description
1-25-23	First Review (IW)
04-19-23	Second Review (IW)

## General Review Information

The petition is located on the north side of Albemarle Road, a State-maintained major throughfare west of Circumferential Road, a City-maintained major throughfare. The petition is located in an east wedge outside of Route 4, within the Rocky River Road Area Plan.

### Active Projects Near the Site:

- No active transportation projects in the vicinity

---

*CDOT's review of this rezoning petition is intended to provide consistency with council adopted policies, plans, standards and guidelines including, but not limited to, the [Transportation Action Plan \(TAP\)](#), [Vision Zero](#), [Urban Street Design Guidelines \(USDG\)](#), [Center, Corridor and Wedges](#), [Charlotte BIKES](#), [Traffic Impact Study Guidelines](#) and [Charlotte WALKS](#). With a commitment to design complete streets, this review is to ensure that the City's transportation network supports current and future land uses and includes streets that provide safe and comfortable mobility for motorists, pedestrians, bicyclists, and transit users.*

*This document is primarily for communication to Planning Department staff as part of the overall City staff analysis of the rezoning petition and includes an overall summary of the case from a transportation perspective, information on trip generation, and resolved or outstanding site plan concerns. Additional advisory information about the driveway permit process is provided for information only.*

---

Based on our review of the petition, we offer the following information for your consideration.

## Transportation Summary

The petition is located on the north side of Albemarle Road, a State-maintained major throughfare west of Circumferential Road, a City-maintained major throughfare. This project is adjacent to the Central/Albemarle Corridor of Opportunity. A Traffic Impact Study (TIS) is not required for this site due to the site generating less than 2,500 trips. Site plan and/or conditional note revisions are needed to commit to streetscape along public roads per Chapter 20 and conditional note revisions. Further details are listed below.

# Rezoning Transportation Analysis

Petition Number: 2022-146

General Location Identifier: 10910206

## Trip Generation

Scenario	Land Use	Intensity	Trip Generation (vehicle trips/day)	Source
Existing Use	Vacant	-	-	Tax Record
Entitlement with Current Zoning	INST, 3.9 acres	-	Too many uses to determine trip generation	General Guidance from Planning
Proposed Zoning	Single Family Attached (R-12MF, 3.9 acres)	46 Dwelling Units	305	Site Plan: 07-25-22
Proposed Zoning	Single Family Attached (R-12MF, 3.9 acres)	47 Dwelling Units	310	Site Plan: 03-10-23

**Petitioner to provide responses to the staff comments below as well as specify other changes to the site plan.**

### Outstanding Issues

**Strikethrough = Resolved**

~~1. **Curblin**:~~

- ~~a. **Dusinane Extension**: Location of curb and gutter to be set appropriately once street is constructed by separate developer.~~

~~NOTE: Additional distance from center line to back of curb may be required in locations where a median is present or around intersections and interchanges.~~

~~Label and dimension the curb and gutter from the centerline for each road on the site plan.~~

~~2. **Traffic Study**:~~

~~A Traffic Impact Study (TIS) is not required for the complete review of this petition due to the site generating less than 2,500 daily trips and/or not triggering any other City TIS requirements.~~

3. Revise site plan and conditional note(s) to commit to construct an 8-foot planting strip, and 5-foot sidewalk on Dusinane Extension per Chapter 20. The site plan shall label and dimension both items from the back of curb and gutter or edge of pavement.

**Clarifying Comment 4-20-23:** Update conditional notes to commit to constructing Dusinane as a U02 and constructing the 8 foot planting strip and 5 foot sidewalk.

- ~~4. **Revise site plan to remove public right of way designation for private streets as shown below. Label and provide CLDSM designation for proposed private streets.**~~

# Rezoning Transportation Analysis

Petition Number: 2022-146

General Location Identifier: 10910206

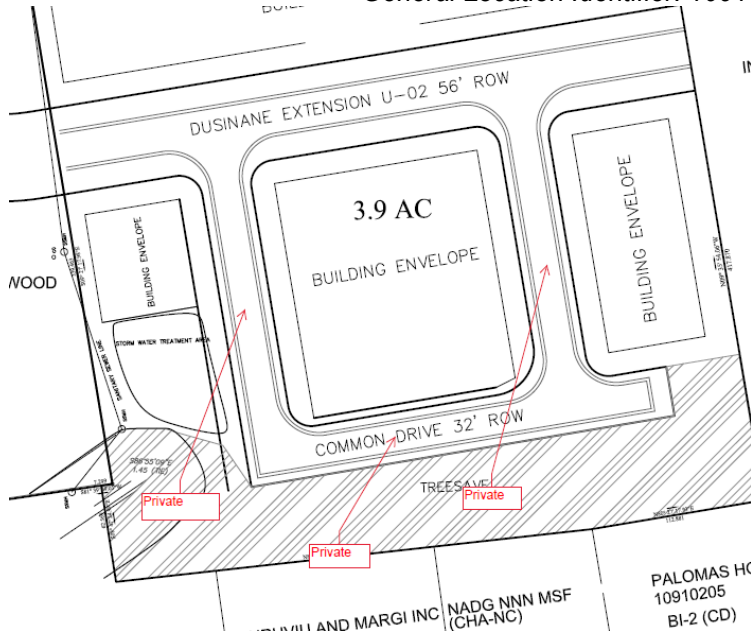

5. Add a conditional note specifying “A Right-of-Way Encroachment Agreement is required for the installation of any non-standard item(s) (irrigation systems, decorative concrete pavement, brick pavers, etc.) within a proposed/existing City-maintained street right-of-way by a private individual, group, business, or homeowner’s/business association. An encroachment agreement must be approved by CDOT prior to construction/installation. Contact CDOT for additional information concerning cost, submittal, and liability insurance coverage requirements.”
6. Add a conditional note specifying “the Petitioner shall dedicate and convey in fee simple all rights-of-way to the City before the site’s first building certificate of occupancy is issued. CDOT requests rights-of-way set at 2’ behind back of sidewalk where feasible.”
7. Add a conditional note specifying “All transportation improvements will be approved and constructed before the site’s first building certificate of occupancy is issued. The petitioner may phase transportation improvements if said improvements and phasing are explicitly described in site plan notes.”

## Advisory Information

The following are requirements of the developer that must be satisfied prior to driveway permit approval. These requirements shall be reflected on the rezoning plan, as appropriate.

1. CDOT has the authority to regulate/approve all private street/driveway and public street connections to the right-of-way of a street under the regulatory jurisdiction of the City of Charlotte, per the City of Charlotte’s Driveway Regulations.
2. Adequate sight triangles must be reserved at the existing/proposed street entrance(s). Two 35’ x 35’ sight triangles (and two 10’ x 70’ sight triangles on NCDOT-maintained streets) are required for the entrance(s) to meet requirements. All proposed trees, berms, walls, fences, and/or identification signs shall not interfere with sight distance at the entrance(s) and shall be identified on the site plan.
3. The proposed driveway connection(s) to public streets will require a driveway permit(s) to be submitted to CDOT (and NCDOT on NCDOT-maintained streets) for review and approval. The exact driveway location(s) and type/width of the driveway(s) will be determined by CDOT during the driveway permit process. The locations of the driveway(s) shown on the site plan are subject to change in order to align

# Rezoning Transportation Analysis

**Petition Number: 2022-146**

*General Location Identifier: 10910206*

with driveway(s) on the opposite side of the street and comply with City Driveway Regulations and the City Tree Ordinance.

4. All proposed commercial driveway connections to a future public street will require a driveway permit submitted to CDOT for review and approval.
5. Any fence or wall constructed along or adjacent to any sidewalk or street right-of-way requires a certificate issued by CDOT.
6. To obtain a street and pedestrian lighting recommendation, the petitioner should visit the following link: <https://charlottenc.gov/Transportation/Programs/Pages/StreetLighting.aspx>