

REZONING PETITION  
FOR PUBLIC HEARING  
2021-XXX

REZONING PETITION

ENDHAVEN AND ELM TOWNS  
CHARLOTTE, NC

HOPPER COMMUNITIES  
1616 CLEVELAND AVE  
CHARLOTTE, NC 28203  
704.805.4803

SCHEMATIC  
SITE PLAN

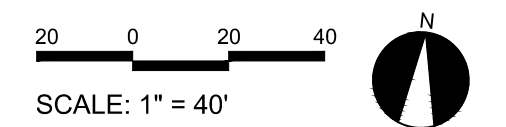

PROJECT #: 598-032  
DRAWN BY: JN  
CHECKED BY: NB

SEPTEMBER 24, 2021

REVISIONS:

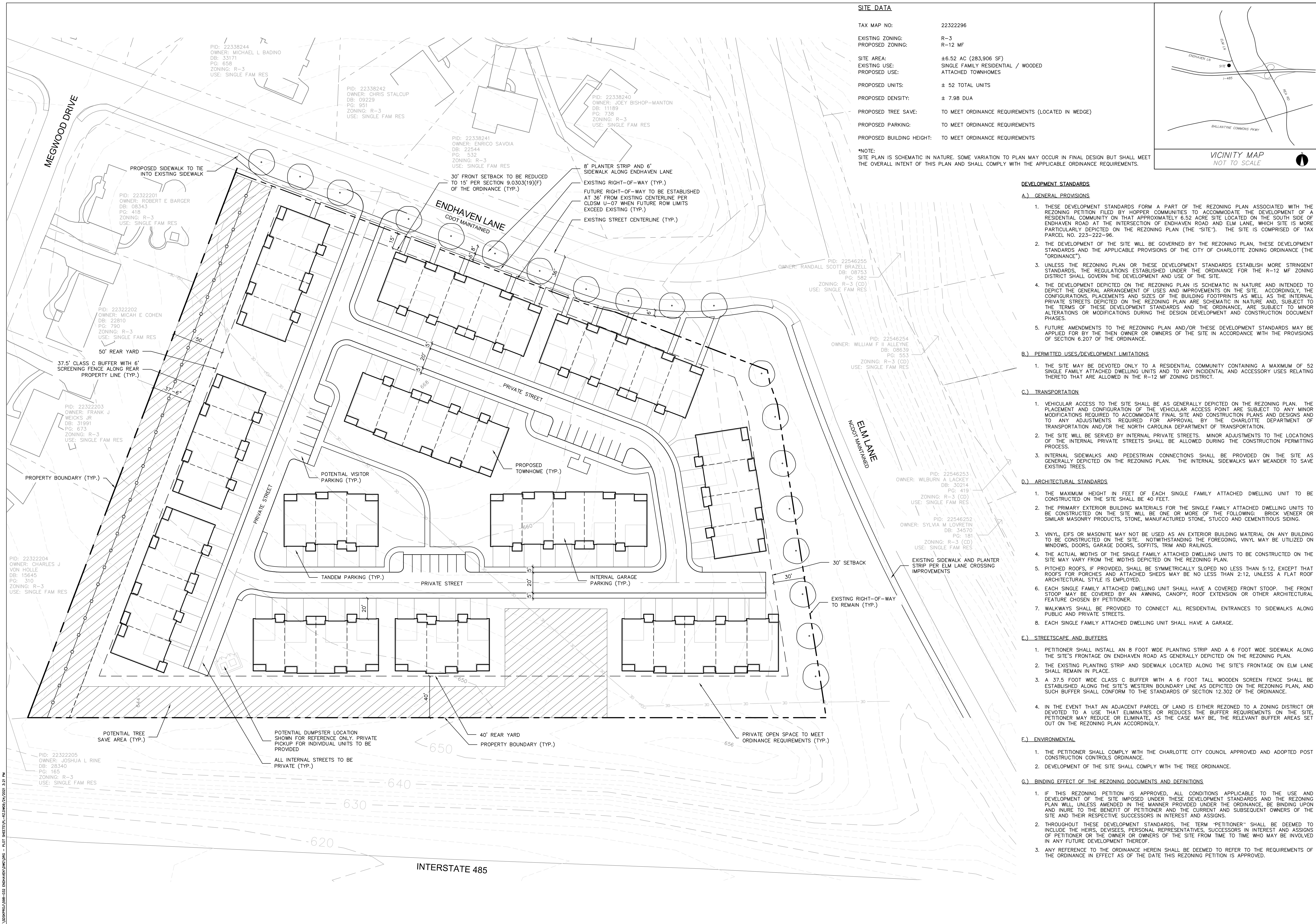

**SITE DATA**

TAX MAP NO: 22322296  
EXISTING ZONING: R-3  
PROPOSED ZONING: R-12 MF  
SITE AREA: ±6.52 AC (283,906 SF)  
EXISTING USE: SINGLE FAMILY RESIDENTIAL / WOODED ATTACHED TOWNHOMES  
PROPOSED USE:  
PROPOSED UNITS: ± 52 TOTAL UNITS  
PROPOSED DENSITY: ± 7.98 DUA  
PROPOSED TREE SAVE: TO MEET ORDINANCE REQUIREMENTS (LOCATED IN WEDGE)  
PROPOSED PARKING: TO MEET ORDINANCE REQUIREMENTS  
PROPOSED BUILDING HEIGHT: TO MEET ORDINANCE REQUIREMENTS

\*NOTE: SITE PLAN IS SCHEMATIC IN NATURE. SOME VARIATION TO PLAN MAY OCCUR IN FINAL DESIGN BUT SHALL MEET THE OVERALL INTENT OF THIS PLAN AND SHALL COMPLY WITH THE APPLICABLE ORDINANCE REQUIREMENTS.

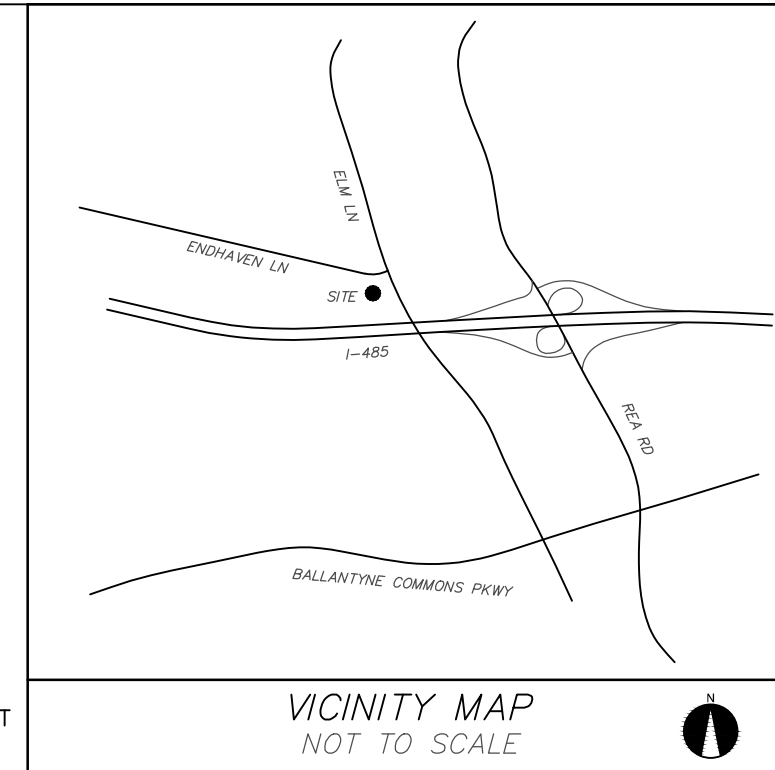

**DEVELOPMENT STANDARDS**

**A.) GENERAL PROVISIONS**

1. THESE DEVELOPMENT STANDARDS FORM A PART OF THE REZONING PLAN ASSOCIATED WITH THE REZONING PETITION FILED BY HOPPER COMMUNITIES TO ACCOMMODATE THE DEVELOPMENT OF A RESIDENTIAL COMMUNITY ON THAT APPROXIMATELY 6.52 ACRE SITE LOCATED ON THE SOUTH SIDE OF ENDAHVEN ROAD AT THE INTERSECTION OF ENDAHVEN ROAD AND ELM LANE, WHICH SITE IS MORE PARTICULARLY DEPICTED ON THE REZONING PLAN (THE "SITE"). THE SITE IS COMPRISED OF TAX PARCEL NO. 223-222-96.
2. THE DEVELOPMENT OF THE SITE WILL BE GOVERNED BY THE REZONING PLAN, THESE DEVELOPMENT STANDARDS AND THE APPLICABLE PROVISIONS OF THE CITY OF CHARLOTTE ZONING ORDINANCE (THE "ORDINANCE").
3. UNLESS THE REZONING PLAN OR THESE DEVELOPMENT STANDARDS ESTABLISH MORE STRINGENT STANDARDS, THE REGULATIONS ESTABLISHED UNDER THE ORDINANCE FOR THE R-12 MF ZONING DISTRICT SHALL GOVERN THE DEVELOPMENT AND USE OF THE SITE.
4. THE DEVELOPMENT DEPICTED ON THE REZONING PLAN IS SCHEMATIC IN NATURE AND INTENDED TO DEPICT THE GENERAL ARRANGEMENT OF USES AND IMPROVEMENTS ON THE SITE. ACCORDINGLY, THE CONFIGURATIONS, PLACEMENTS AND SIZES OF THE BUILDING FOOTPRINTS AS WELL AS THE INTERNAL PRIVATE STREETS DEPICTED ON THE REZONING PLAN ARE SCHEMATIC IN NATURE AND, SUBJECT TO THE TERMS OF THESE DEVELOPMENT STANDARDS AND THE ORDINANCE, ARE SUBJECT TO MINOR ALTERATIONS OR MODIFICATIONS DURING THE DESIGN DEVELOPMENT AND CONSTRUCTION DOCUMENT PHASES.
5. FUTURE AMENDMENTS TO THE REZONING PLAN AND/OR THESE DEVELOPMENT STANDARDS MAY BE APPLIED FOR BY THE THEN OWNER OR OWNERS OF THE SITE IN ACCORDANCE WITH THE PROVISIONS OF SECTION 6.207 OF THE ORDINANCE.

**B.) PERMITTED USES/DEVELOPMENT LIMITATIONS**

1. THE SITE MAY BE DEVOTED ONLY TO A RESIDENTIAL COMMUNITY CONTAINING A MAXIMUM OF 52 SINGLE FAMILY ATTACHED DWELLING UNITS AND TO ANY INCIDENTAL AND ACCESSORY USES RELATING THERETO THAT ARE ALLOWED IN THE R-12 MF ZONING DISTRICT.

**C.) TRANSPORTATION**

1. VEHICULAR ACCESS TO THE SITE SHALL BE AS GENERALLY DEPICTED ON THE REZONING PLAN. THE PLACEMENT AND CONFIGURATION OF THE VEHICULAR ACCESS POINT ARE SUBJECT TO ANY MINOR MODIFICATIONS REQUIRED TO ACCOMMODATE FINAL SITE AND CONSTRUCTION PLANS AND DESIGNS AND TO ANY ADJUSTMENTS REQUIRED FOR APPROVAL BY THE CHARLOTTE DEPARTMENT OF TRANSPORTATION AND/OR THE NORTH CAROLINA DEPARTMENT OF TRANSPORTATION.
2. THE SITE WILL BE SERVED BY INTERNAL PRIVATE STREETS. MINOR ADJUSTMENTS TO THE LOCATIONS OF THE INTERNAL PRIVATE STREETS SHALL BE ALLOWED DURING THE CONSTRUCTION PERMITTING PROCESS.
3. INTERNAL SIDEWALKS AND PEDESTRIAN CONNECTIONS SHALL BE PROVIDED ON THE SITE AS GENERALLY DEPICTED ON THE REZONING PLAN. THE INTERNAL SIDEWALKS MAY MEANDER TO SAVE EXISTING TREES.

**D.) ARCHITECTURAL STANDARDS**

1. THE MAXIMUM HEIGHT IN FEET OF EACH SINGLE FAMILY ATTACHED DWELLING UNIT TO BE CONSTRUCTED ON THE SITE SHALL BE 40 FEET.
2. THE PRIMARY EXTERIOR BUILDING MATERIALS FOR THE SINGLE FAMILY ATTACHED DWELLING UNITS TO BE CONSTRUCTED ON THE SITE WILL BE ONE OR MORE OF THE FOLLOWING: BRICK VENEER OR SIMILAR MASONRY PRODUCTS, STONE, MANUFACTURED STONE, STUCCO AND CEMENTITIOUS SIDING.
3. VINYL, EIFS OR MASONITE MAY NOT BE USED AS AN EXTERIOR BUILDING MATERIAL ON ANY BUILDING TO BE CONSTRUCTED ON THE SITE. NOTWITHSTANDING THE FOREGOING, VINYL MAY BE UTILIZED ON WINDOWS, DOORS, GARAGE DOORS, SOFFITS, TRIM AND RAILINGS.
4. THE ACTUAL WIDTHS OF THE SINGLE FAMILY ATTACHED DWELLING UNITS TO BE CONSTRUCTED ON THE SITE MAY VARY FROM THE WIDTHS DEPICTED ON THE REZONING PLAN.
5. PITCHED ROOFS, IF PROVIDED, SHALL BE SYMMETRICALLY SLOPED NO LESS THAN 5:12, EXCEPT THAT ROOFS FOR PORCHES AND ATTACHED SHEDS MAY BE NO LESS THAN 2:12, UNLESS A FLAT ROOF ARCHITECTURAL STYLE IS EMPLOYED.
6. EACH SINGLE FAMILY ATTACHED DWELLING UNIT SHALL HAVE A COVERED FRONT STOOP. THE FRONT STOOP MAY BE COVERED BY AN AWNING, CANOPY, ROOF EXTENSION OR OTHER ARCHITECTURAL FEATURE CHOSEN BY PETITIONER.
7. WALKWAYS SHALL BE PROVIDED TO CONNECT ALL RESIDENTIAL ENTRANCES TO SIDEWALKS ALONG PUBLIC AND PRIVATE STREETS.
8. EACH SINGLE FAMILY ATTACHED DWELLING UNIT SHALL HAVE A GARAGE.

**E.) STREETScape AND BUFFERS**

1. PETITIONER SHALL INSTALL AN 8 FOOT WIDE PLANTING STRIP AND A 6 FOOT WIDE SIDEWALK ALONG THE SITE'S FRONTAGE ON ENDAHVEN ROAD AS GENERALLY DEPICTED ON THE REZONING PLAN.
2. THE EXISTING PLANTING STRIP AND SIDEWALK LOCATED ALONG THE SITE'S FRONTAGE ON ELM LANE SHALL REMAIN IN PLACE.
3. A 37.5 FOOT WIDE CLASS C BUFFER WITH A 6 FOOT TALL WOODEN SCREEN FENCE SHALL BE ESTABLISHED ALONG THE SITE'S WESTERN BOUNDARY LINE AS DEPICTED ON THE REZONING PLAN, AND SUCH BUFFER SHALL CONFORM TO THE STANDARDS OF SECTION 12.302 OF THE ORDINANCE.
4. IN THE EVENT THAT AN ADJACENT PARCEL OF LAND IS EITHER REZONED TO A ZONING DISTRICT OR DEVOTED TO A USE THAT ELIMINATES OR REDUCES THE BUFFER REQUIREMENTS ON THE SITE, PETITIONER MAY REDUCE OR ELIMINATE, AS THE CASE MAY BE, THE RELEVANT BUFFER AREAS SET OUT ON THE REZONING PLAN ACCORDINGLY.

**F.) ENVIRONMENTAL**

1. THE PETITIONER SHALL COMPLY WITH THE CHARLOTTE CITY COUNCIL APPROVED AND ADOPTED POST CONSTRUCTION CONTROLS ORDINANCE.
2. DEVELOPMENT OF THE SITE SHALL COMPLY WITH THE TREE ORDINANCE.

**G.) BINDING EFFECT OF THE REZONING DOCUMENTS AND DEFINITIONS**

1. IF THIS REZONING PETITION IS APPROVED, ALL CONDITIONS APPLICABLE TO THE USE AND DEVELOPMENT OF THE SITE IMPOSED UNDER THESE DEVELOPMENT STANDARDS AND THE REZONING PLAN WILL, UNLESS AMENDED IN THE MANNER PROVIDED UNDER THE ORDINANCE, BE BINDING UPON AND INURE TO THE BENEFIT OF PETITIONER AND THE CURRENT AND SUBSEQUENT OWNERS OF THE SITE AND THEIR RESPECTIVE SUCCESSORS IN INTEREST AND ASSIGNS.
2. THROUGHOUT THESE DEVELOPMENT STANDARDS, THE TERM "PETITIONER" SHALL BE DEEMED TO INCLUDE THE HEIRS, DEVISEES, PERSONAL REPRESENTATIVES, SUCCESSORS IN INTEREST AND ASSIGNS OF PETITIONER OR THE OWNER OR OWNERS OF THE SITE FROM TIME TO TIME WHO MAY BE INVOLVED IN ANY FUTURE DEVELOPMENT THEREOF.
3. ANY REFERENCE TO THE ORDINANCE HEREIN SHALL BE DEEMED TO REFER TO THE REQUIREMENTS OF THE ORDINANCE IN EFFECT AS OF THE DATE THIS REZONING PETITION IS APPROVED.