

Site Development Data:
 Acreage: ±0.34
 Tax Parcel #: 081-085-01 and 081-085-02
 Existing Zoning: I-2
 Proposed Zoning: UR-2(CD)
 Existing Uses: Vacant
 Proposed Uses: Up to ten (10) townhouse Residential Dwelling Units Maximum Building Height: Up to forty (40) feet as measured per Ordinance
 Parking: Shall meet or exceed Ordinance standard

Tree Save Data:
 Site Area: 15,000 S.F.
 Required Tree Save Area:
 Developer intends to use Amenity Tree Save Area per Section 21-94-b-4b

Development Data Table:

Site Area:	+/- 0.3 acres
Tax Parcels:	081-085-01 and 081-085-02
Proposed Zoning:	UR-2(CD)
Existing Use:	Vacant
Proposed Uses:	Up to ten (10) townhouse Residential Dwelling Units

Maximum Building Height: Up to Forty (40) feet as measured per the Ordinance
 Parking: Shall meet or exceed Ordinance standards

- I. General Provisions**
- These Development Standards form a part of the Rezoning Plan associated with the Rezoning Petition filed by Legacy Construction Unlimited Inc. (the "Petitioner") to accommodate the development of residential townhouse on that approximately 0.346-acre site located at 1003 Seigle Avenue, more particularly depicted on the Rezoning Plan (the "Site"). The Site is comprised of Tax Parcel Numbers 081-085-01 and 081-085-02.
 - Development of the Site will be governed by the Rezoning Plan, these Development Standards and the applicable provisions of the City of Charlotte Zoning Ordinance (the "Ordinance").
 - Unless the Rezoning Plan or these Development Standards establish more stringent standards, the regulations established under the Ordinance for the UR-2 zoning district shall govern the development and use of the Site.
 - The development and street layout depicted on the Rezoning Plan are schematic in nature and are intended to depict the general arrangement of such uses and improvements on the Site. Accordingly, the ultimate layout, locations and sizes of the development and site elements depicted on the Rezoning Plan are graphic representations of the proposed development and site elements, and they may be altered or modified in accordance with the setback, yard, landscaping and tree save requirements set forth on this Rezoning Plan and the Development Standards, provided, however, that any such alterations and modifications shall be minor in nature and not materially change the overall design intent depicted on the Rezoning Plan.
 - Future amendments to the Rezoning Plan and/or these Development Standards may be applied for by the then owner(s) of the Site in accordance with the provisions of Chapter 6 of the Ordinance. Minor alterations to the Rezoning Plan are subject to Section 6.207 of the Ordinance.

II. Permitted Uses & Maximum Development
 The Site may be devoted only to residential uses and any incidental and accessory uses relating thereto that are allowed in the UR-2 zoning district. The Site shall contain a maximum of two (2) townhouse residential buildings for a total number of ten (10) residential units.

- III. Transportation**
- Access to the Site shall be as generally depicted on the Rezoning Plan and minor adjustments shall be allowed during the construction permitting process in coordination with CDDT.
 - Petitioner shall construct a minimum six (6) foot wide sidewalk and eight (8) foot wide planting strip along the Site's frontage of Van Every Street as generally depicted on the Rezoning Plan.
 - Petitioner shall dedicate all rights-of-way in fee simple conveyance to the City of Charlotte before the Site's first building certificate of occupancy is issued.
 - All transportation improvements shall be substantially constructed prior to the issuance of the Site's first building certificate of occupancy.

- IV. Architectural Standards**
- Preferred Exterior Building Materials: The primary building material will be wood and/or hard-board resembling traditional wood siding. Secondary building materials may include a combination of portions of brick, natural stone (or its synthetic equivalent), stucco, cementitious siding, fiber cement (e.g., "HardiPlank"), aluminum wrapped wood fascia, and/or other materials approved by the Planning Director.
 - Prohibited Exterior Building Materials: (i) vinyl siding, excluding vinyl handrails, windows, soffits or door trim, and (ii) concrete masonry units not architecturally finished.
 - Fitted roofs, if provided, shall be symmetrically sloped no less than 5:12, except that roofs for porches and/or sheds may be no less than 2:12, unless a flat roof architectural style is employed.
 - Petitioner shall provide pedestrian connections or stairs from every unit to the sidewalk along Van Every Street, as generally depicted on the Rezoning Plan.
 - To provide privacy, all residential entrances within fifteen (15) feet of a public sidewalk, if applicable, shall be raised or lowered from the average sidewalk grade twelve (12) to twenty-four (24) inches.
 - The corner/end unit fronting the intersection of Van Every Street and Seigle Avenue shall have a porch or stoop that wraps a portion of the front and side of the unit or provide blank wall provisions that limit the maximum blank wall expanse to ten (10) feet on all building levels for that corner/end.
 - Stoops and/or porches shall form a predominant feature of the building design and be located along Van Every Street and/or Seigle Avenue, as applicable. Elevations fronting Van Every Street and/or Seigle Avenue shall not contain blank wall expanses greater than fifteen (15) feet on all building levels, to be treated with design elements including but not limited to doors, windows, awnings, and/or architectural design elements such as changes in material and/or color, projections, or offsets.
 - All units shall be provided with a garage for a minimum of one (1) car. Garage doors visible from public streets, if applicable, shall minimize the visual impact by providing a setback of 12 to 24 inches from the front wall plane and additional architectural treatments such as translucent windows or projecting elements over the garage door opening.

- V. Environmental Features**
- The Petitioner shall comply with the Charlotte City Council approved and adopted Post Construction Stormwater Ordinance. The location, size, and type of stormwater management systems are subject to review and approval as part of the full development plan submittal and are not implicitly approved with this rezoning. Adjustments may be necessary to accommodate actual stormwater treatment requirements and natural site discharge points.
 - The Petitioner shall comply with Tree Ordinance requirements.

VI. Amendments to Rezoning Plan
 Future amendments to the Rezoning Plan and these Development Standards may be applied for by the then Owner or Owners of a particular Tract within the Site involved in accordance with the provisions of Chapter 6 of the Ordinance.

VII. Binding Effect of the Rezoning Documents and Definitions
 If this Rezoning Petition is approved, all conditions applicable to development of the Site imposed under the Rezoning Plan and these Development Standards will, unless amended in the manner provided under the Ordinance, be binding upon and inure to the benefit of the Petitioner and subsequent owners of the Site and their respective successors in interest and assigns. Throughout these Development Standards, the terms, "Petitioner" and "Owner" or "Owners" shall be deemed to include the heirs, devisees, personal representatives, successors in interest and assigns of the Petitioner or the owner or owners of any part of the Site from time to time who may be involved in any future development thereof.

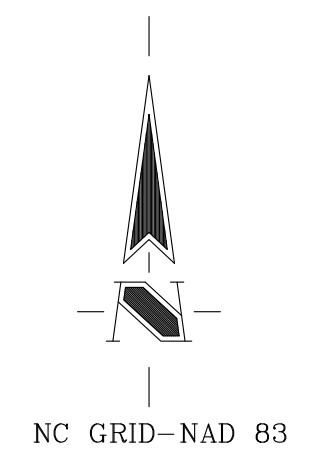
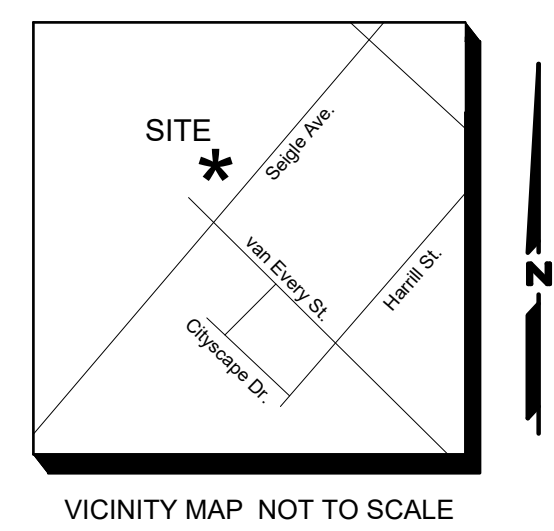
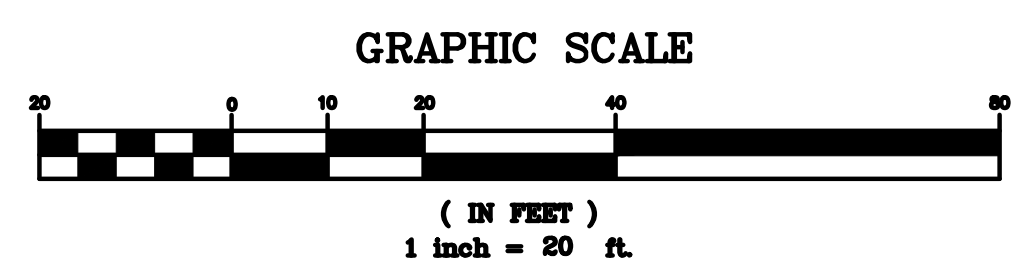
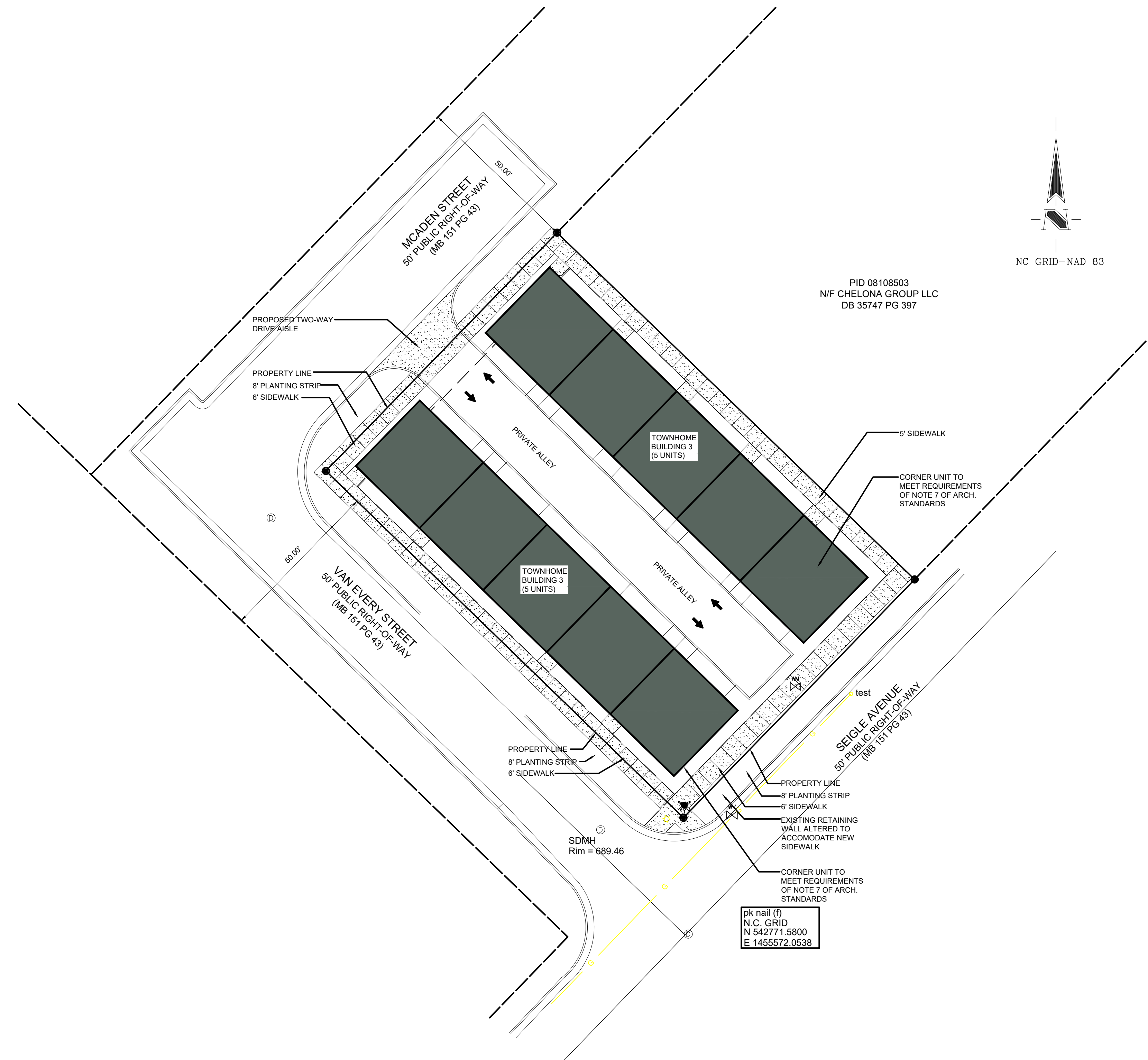

PID 08108503
 N/F CHELONA GROUP LLC
 DB 35747 PG 397

pk nail (f)
 N.C. GRID
 N 542771.5800
 E 1455572.0538

AMERICAN ARCHITECTURE COLLABORATIVE, PLLC
 4010 ALBEMARLE RD, SUITE 204
 CHARLOTTE, NC 28206
 TEL: 704.353.1905
 FAX: 704.376.7122

DATE: 10/19/21
THIS DOCUMENT IS THE PROPERTY OF AAC, PLLC, AND IS NOT TO BE REPRODUCED IN WHOLE OR IN PART WITHOUT THE PERMISSION OF THE DEVELOPER.

NEW TOWN HOMES:
 LEGACY CONTRUCTION
 1003 & 1005 SEIGLE AV.
 CHARLOTTE, NC 28205
FIRST FLOOR PLAN

NO.	DATE	DESCRIPTION
1	1/2/20	ISSUE TO OWNER
2		
3		

DATE: MAY 20, 2021
 SCALE: AS NOTED
 DRAWN BY: HJJ
 CHECKED BY: AVH
 JOB NO: 21-401
 CAD FILE: TOWNHOME