

REALTY ADVISORY CORPORATION LLC  
REZONING PETITION NO. 2020-xxx  
1/29/2020

**I. General Provisions**

- These Development Standards form a part of the Rezoning Plan associated with the Rezoning Petition filed by Realty Advisory Corporation LLC (the "Petitioner") to accommodate the development of a single-family attached (townhome) residential community on that approximately 0.44-acre site located at the northeast intersection of East 7th Street and Firefighter Place, more particularly depicted on the Rezoning Plan (the "Site"). The Site is comprised of Tax Parcel Number 127-092-21 and 127-092-22.
- Development of the Site will be governed by the Rezoning Plan, these Development Standards and the applicable provisions of the City of Charlotte Zoning Ordinance (the "Ordinance").
- Unless the Rezoning Plan or these Development Standards establish more stringent standards, the regulations established under the Ordinance for the UR-2 zoning district shall govern the development and use of the Site.
- The development and street layout depicted on the Rezoning Plan are schematic in nature and are intended to depict the general arrangement of such uses and improvements on the Site. Accordingly, the ultimate layout, locations and sizes of the development and site elements depicted on the Rezoning Plan are graphic representations of the proposed development and site elements, and they may be altered or modified in accordance with the setback, yard, landscaping and tree save requirements set forth on this Rezoning Plan and the Development Standards, provided, however, that any such alterations and modifications shall be minor in nature and not materially change the overall design intent depicted on the Rezoning Plan.
- Future amendments to the Rezoning Plan and/or these Development Standards may be applied for by the then owner(s) of the Site in accordance with the provisions of Chapter 6 of the Ordinance. Minor alterations to the Rezoning Plan are subject to Section 6.207 of the Ordinance.

**II. Permitted Uses**

The Site may be devoted only to a residential community containing a maximum of ten (10) single-family attached dwelling units and any incidental and accessory uses relating thereto that are permitted in the UR-2 zoning district.

**III. Transportation**

- Vehicular access to the Site shall be as generally depicted on the Rezoning Plan. The placement and configuration of the vehicular access points are subject to any minor modifications required to accommodate final site and construction plans and designs and as required for approval by the Charlotte Department of Transportation (CDOT).
- As depicted on the Rezoning Plan, the Site will be served by internal private alleys, and minor adjustments to the location of these streets/alleys shall be allowed during the construction permitting process in coordination with CDOT.
- Petitioner shall provide internal sidewalks and pedestrian connections on the Site as generally depicted on the Rezoning Plan. Internal sidewalks may meander to save existing trees.
- Petitioner shall dedicate all rights-of-way where necessary, in fee simple conveyance to the City of Charlotte prior to the issuance of the Site's first building certificate of occupancy.
- Unless stated otherwise herein, the Petitioner shall ensure that all transportation improvements are substantially completed prior to the issuance of the Site's first building certificate of occupancy.

**IV. Architectural & Landscaping Standards**

- Preferred Exterior Building Materials: All principal and accessory buildings shall be comprised of a combination of portions of brick, brick veneer, natural stone (or its synthetic equivalent), stucco, cementitious siding, fiber cement ("HardiPlank") and/or other materials approved by the Planning Director.
- Prohibited Exterior Building Materials: (i) vinyl siding, excluding vinyl handrails, windows, soffits, doors, garage doors, railings, or trim, and (ii) concrete masonry units not architecturally finished.
- Pitched roofs, if provided, shall be symmetrically sloped no less than 5:12, except that roofs for porches and attached sheds may be no less than 2:12, unless a flat roof architectural style is employed.
- Roof overhangs, eaves, cornices, chimneys, gutters, vents, bay windows, pilasters, pillars, open porches (if provided), and other architectural elements may project up to twenty-four (24) inches into the required setbacks.
- Corner/end units fronting public streets shall have enhanced side elevations to limit the maximum blank wall expanse to twenty (20) feet on each level of the unit.
- For all units, Petitioner shall provide blank wall provisions that limit the maximum blank wall expanse to thirty (30) feet on all building levels, including but not limited to doors, windows, awnings, material or color changes, and/or architectural design elements.
- Rooftop terraces may be installed on any/all units on the Site, at the Petitioner's option.
- All townhome units shall be provided with a garage for a minimum of one (1) car.
- The Petitioner may subdivide the Site and create lots within the Site with no side or rear yards as part of a unified development plan.
- The 10' Vegetated Area, as generally depicted on the Rezoning Plan, may be removed in the event that parcel 127-092-21 is redeveloped to a use other than single-family residential.

**V. Environmental Features**

- The Petitioner shall comply with the Charlotte City Council approved and adopted Post Construction Stormwater Ordinance. The location, size, and type of storm water management systems depicted on the Rezoning Plan are subject to review and approval as part of the full development plan submittal and are not implicitly approved with this rezoning. Adjustments may be necessary in order to accommodate actual storm water treatment requirements and natural site discharge points.
- The Petitioner shall comply with the Charlotte Tree Ordinance.

**VI. Lighting**

All freestanding lighting fixtures installed on the Site greater than twenty one (21) feet in total height (i.e., excluding decorative lighting less than 21' in height that may be installed along the driveways and sidewalks as pedestrian/landscaping lighting) shall be fully capped and shielded and the illumination downwardly directed.

**VII. Binding Effect of the Rezoning Documents and Definitions**

If this Rezoning Petition is approved, all conditions applicable to development of the Site imposed under the Rezoning Plan and these Development Standards will, unless amended in the manner provided under the Ordinance, be binding upon and inure to the benefit of the Petitioner and subsequent owners of the Site and their respective successors in interest and assigns.

Throughout these Development Standards, the terms, "Petitioner" and "Owner" or "Owners" shall be deemed to include the heirs, devisees, personal representatives, successors in interest and assigns of the Petitioner or the owner or owners of any part of the Site from time to time who may be involved in any future development thereof.

This Plan Is A Preliminary Design.  
NOT Released For Construction.

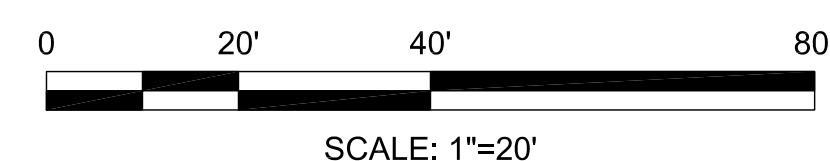
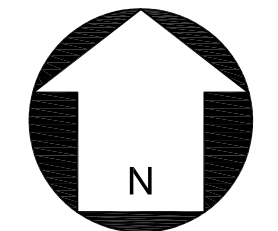

**REVISIONS:**

No.	Date	By	Description



P:\2019 Jobs\19024 - Firefighter Place Towns - Hinshaw\CAD\Sketch Planning\19024\_RZ.dwg

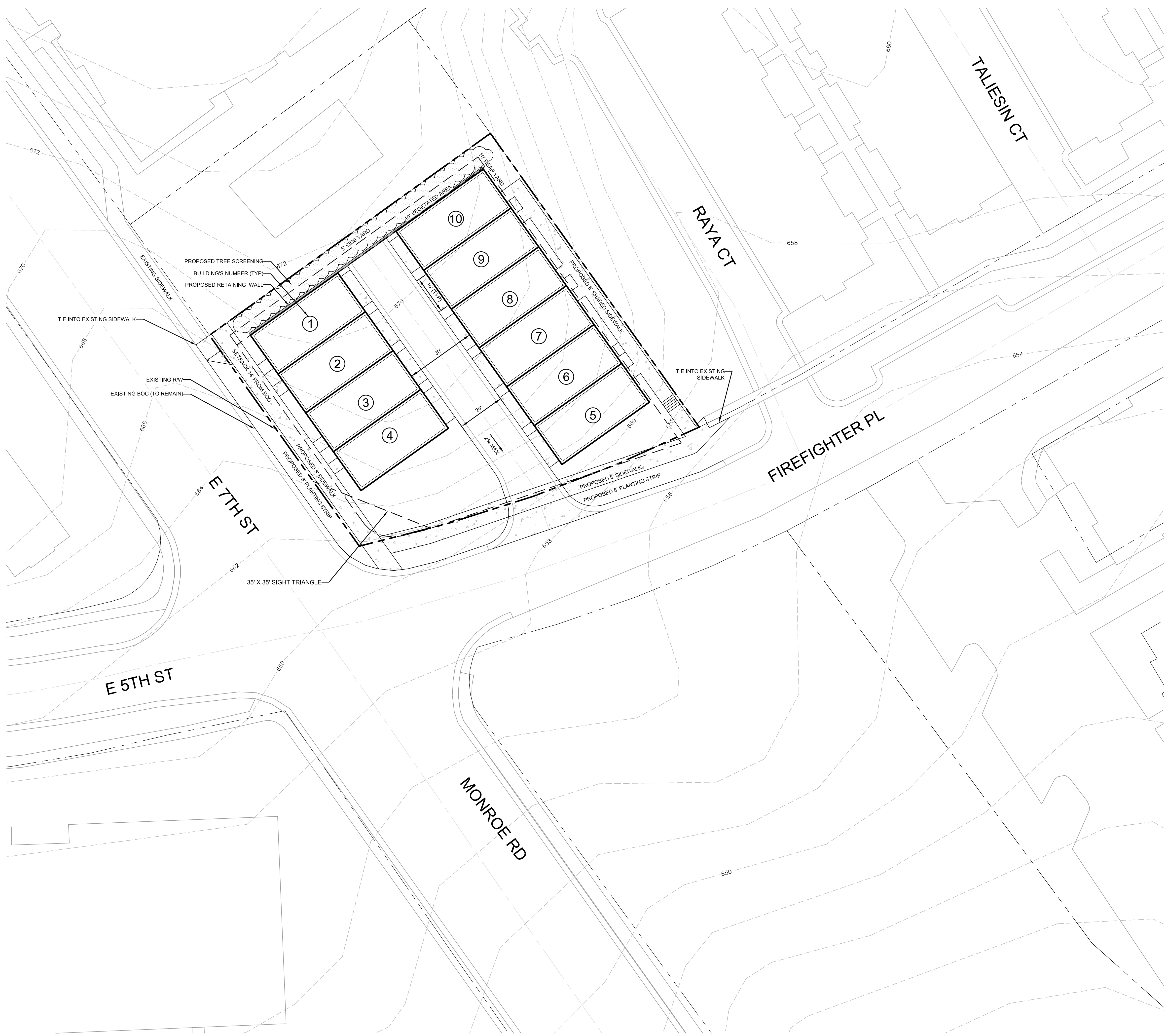

**DEVELOPMENT DATA:**

SITE AREA: 40.44 AC  
 TAX PARCEL ID: 12709221 and 12709222

EXISTING ZONING: R-22MF  
 PROPOSED ZONING: UR-2(CD)

EXISTING USE: VACANT  
 PROPOSED USES: UP TO TEN (10) SINGLE-FAMILY ATTACHED (TOWNHOME) DWELLING UNITS

PROPOSED DENSITY: 22.62 UNITS/ AC

SETBACK: 14' (FROM EXISTING OR PROPOSED BOC)  
 SIDE YARD: 5'  
 REAR YARD: 10'  
 MAX. BLDG HT: UP TO FORTY-EIGHT (48) FEET, AS MEASURED PER THE ORDINANCE

PARKING: SHALL MEET OR EXCEED ORDINANCE STANDARDS

TREE SAVE REQUIRED: 15% (±2875 SF) - PAYMENT IN LIEU OPTION BELOW PCO THRESHOLD

WATER QUALITY:

**LEGEND:**

PROPERTY BOUNDARY:

EXISTING SIDEWALK:

PROPOSED SIDEWALK:

PROPOSED BUILDING:

EXISTING BUILDING:

EXISTING CURB & GUTTER:

PROPOSED CURB & GUTTER:

ROAD CENTERLINE:

EXISTING LOT LINE:

PROPOSED SETBACK LINE:

PROPOSED VEGETATION:

PROPOSED SIGHT TRIANGLE:

PROPOSED WALL:

This Plan Is A Preliminary Design.  
 NOT Released For Construction.

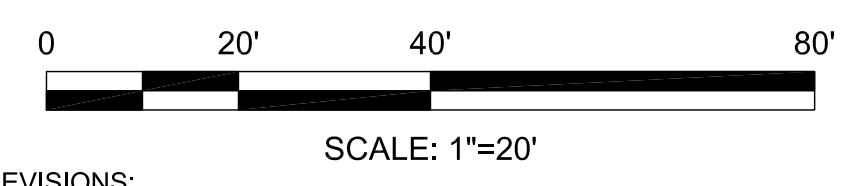

REVISIONS:

No.	Date	By	Description

**Landworks**  
 Design Group, PA  
 CREATING SPACES TO LIVE, WORK AND PLAY  
 tel: 704-841-1604  
 fax: 704-841-1604

7671 Little Avenue, Suite 111  
 Charlotte, NC 28226

**FIREFIGHTER PLACE TOWNS**  
 CHARLOTTE, NC  
 Realty Advisory Corporation LLC  
 Charlotte, NC

**SKETCH PLAN**

CORPORATE CERTIFICATIONS  
 NC PE : C-2930 NC LA : C-253  
 SC ENG : NO. 3599 SC LA : NO. 211

Project Manager: MDL  
 Drawn By: SCJ  
 Checked By: MDL  
 Date: 01/30/20  
 Project Number: 19024  
 Sheet Number:

**RZ-2**  
 SHEET # 2 OF 2